

# SHAD

## ZONTES ZT 125-Z2 '21 TOP MASTER ZOZT11ST

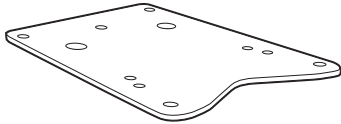

1 262758 x1

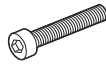

2 304037 x2  
M6 x 35  
DIN 912



3 303017 x6  
Ø6



4 302021 x4  
M6



5 262759 x1

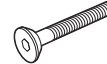

6 304029 x2  
M6 x 35  
DIN 7991



7 262760 x1



### WARNING!

- Compatible with Small (D1B29PA) & Medium (D1B40PA) mounting plates. (NOTE): Compatible with TOP CASES SH26 – SH47 only.  
- **ATTENTION:** top fitting not compatible with aluminium mounting plate (D1BTRPA) or Large mounting plate (D1B481PA).

**GB** Do not fully tighten the screws until it is ensured that the KIT is correctly attached and aligned.

**E** No apretar los tornillos del todo hasta asegurarse que el KIT está correctamente colocado y alineado.

**D** Ziehen Sie die Schrauben nicht ganz fest, bevor Sie sich nicht vergewissert haben, daß der Bausatz korrekt eingestellt und ausgerichtet ist.

**I** Non stringere del tutto le viti fin tanto non si è sicuri che il kit è collocato correttamente e allineato.

**F** Ne pas serrer les vis avant d'être sûr que le KIT soit correctement positionné et ajusté.

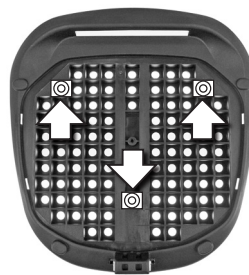
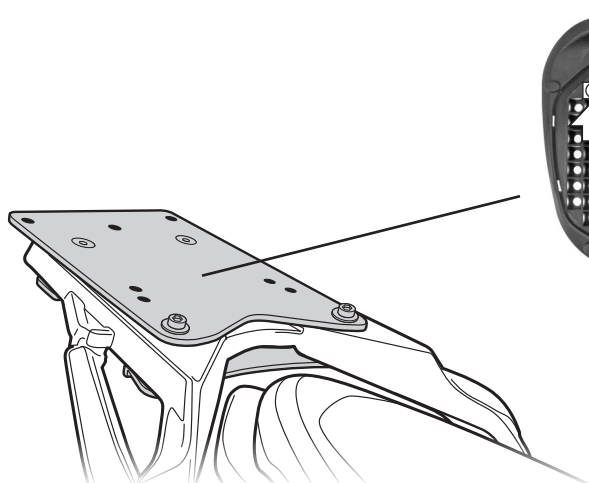
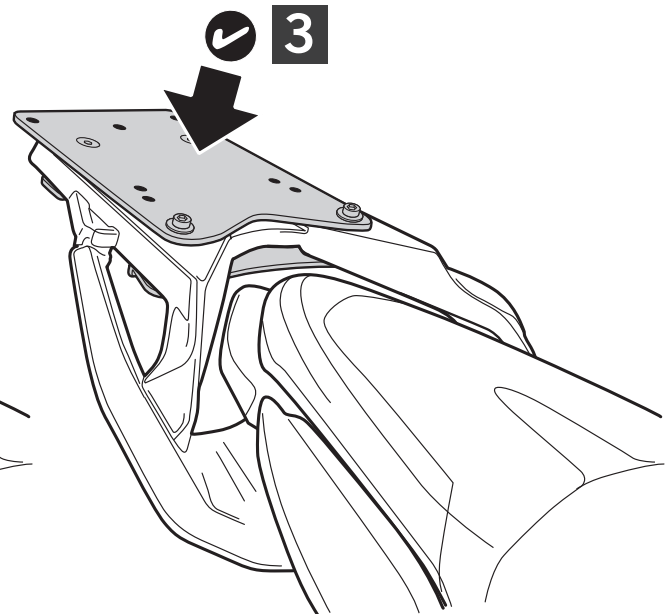
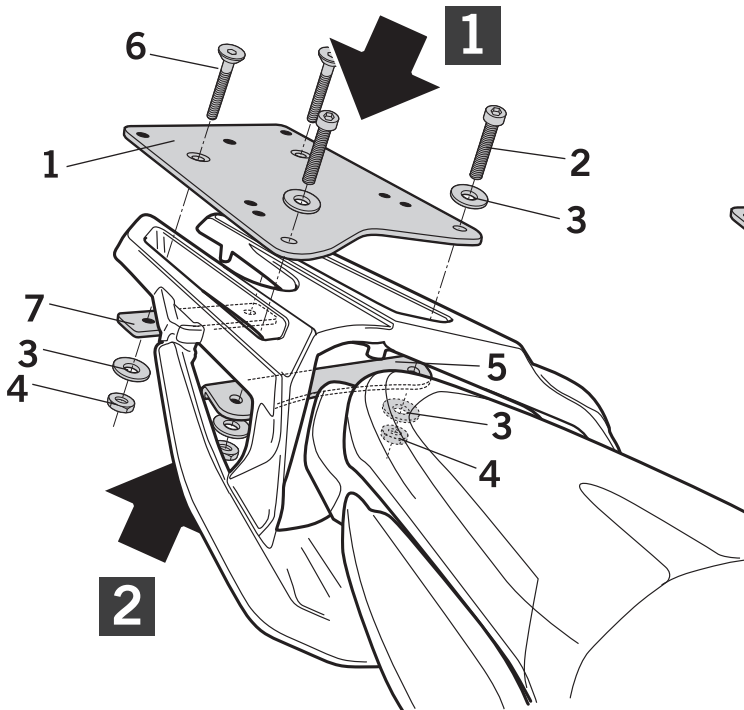

SH29

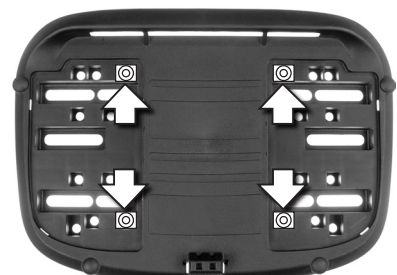

SH40

[www.shad.es](http://www.shad.es)

REF. 500479 Edición 1ª

**IMPORTANT:** Based on European models. For compatibility with models in other continents, check [www.shad.es](http://www.shad.es)